

Grinder pumps for heavy duty applications

Applications:

Drainage of sewage and dirty water, operation in septic tanks and purifying installations.

- For removal of sewage from premises, small houses and buildings located at a distance and below the main sewer system.
- Removal of sewage from basements.
- Removal of sewage from hotels, motels, restaurants, holiday villages and seaside premises.
- For petrol stations, garages and motorway service stations.
- For drainage purposes.
- Removal of fibrous waste from purifying plants.
- For slaughter houses, paper plants, food processing plants, agricultural and similar fields.

Materials:

- Motor casing and volute casing in cast iron GG-20
- Shaft Stainless steel (1.4021)
- Pump impeller (Vortex) cast iron GG-25
- Bolts and nuts in Stainless steel
- Stationary and rotating blades in hardened machined special steel
- Mechanical seal SIC/SIC - NBR
- Cable H07RN-f

Motor:

- Asynchronous, two poles.
- IP 68 protection.
- Class F insulation.
- Continuous operation.
- Three phase version water-cooled motor.
- Built-in thermal protection by thermistors.
- Seal leak sensor in oil chamber.

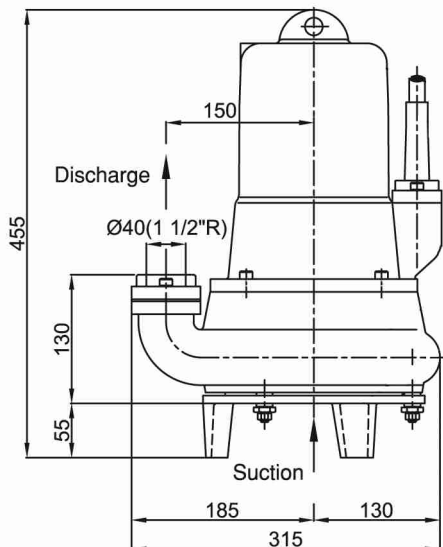
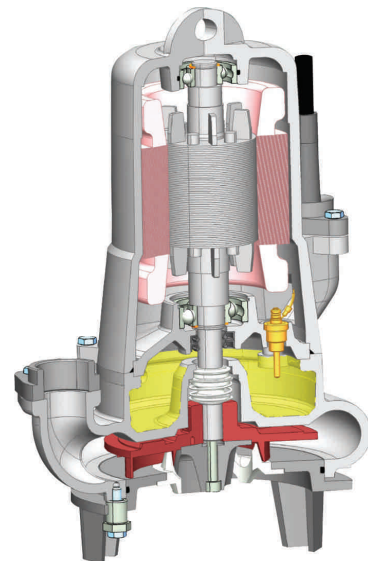
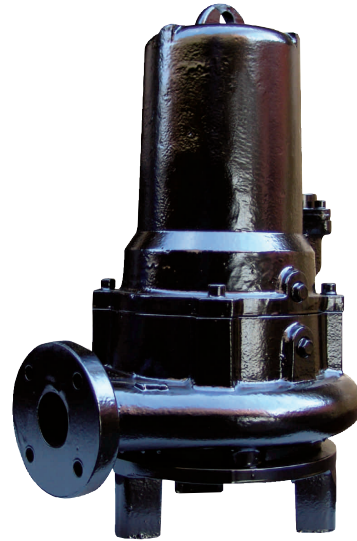

GMG 40

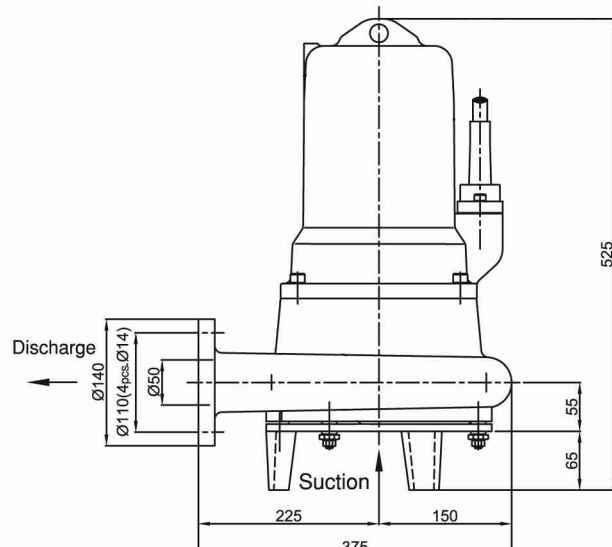

GMG 50

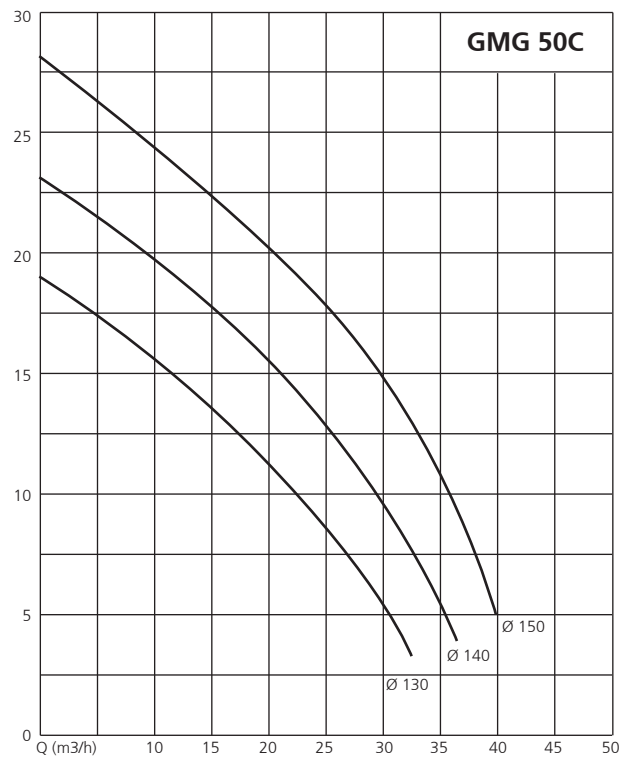
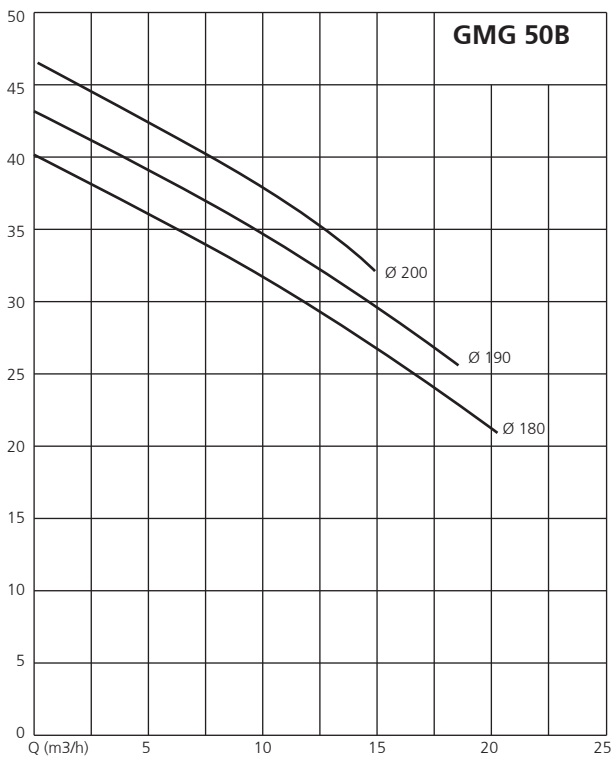
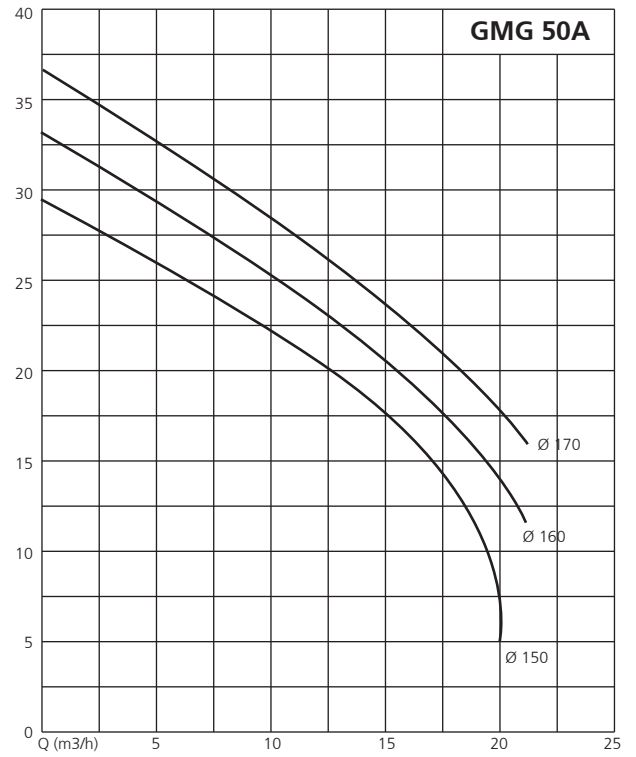
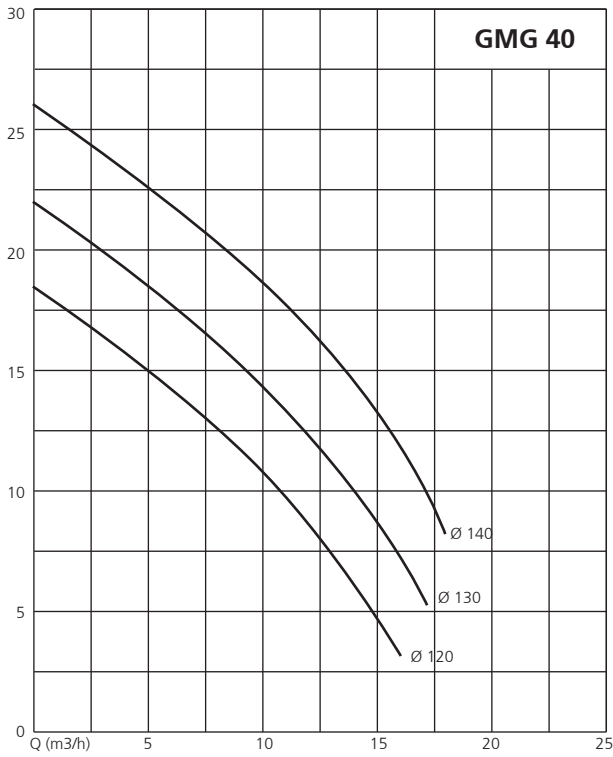

GMG 40

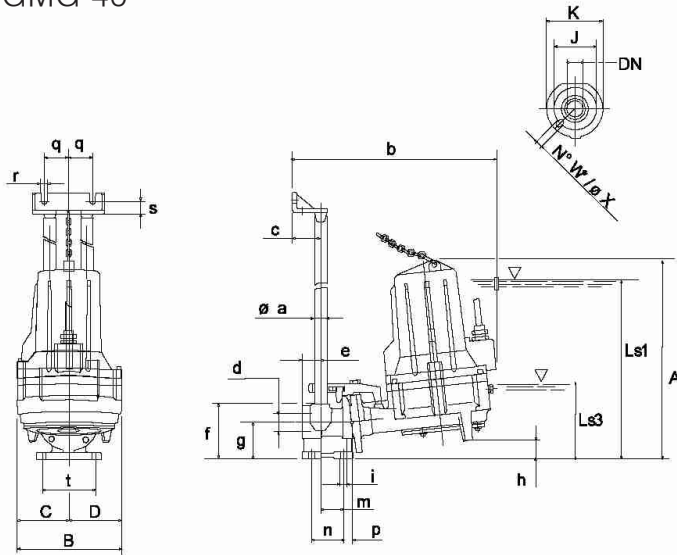

A	B	b	C	c	D	d
437	224	463	112	60	112	1 1/2"

DN	e	f	g	h	i	Jmax
40/PN6	40	120	80	37	14	110

Jmin	K	Ls1	Ls3	m	n	Øa
100	146	371	171	50	70	3/4"

ØX	p	q	r	s	t	W
18	15	52.5	12	27	115	4

GMG 50

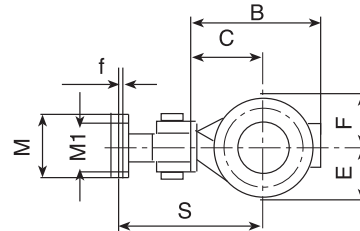
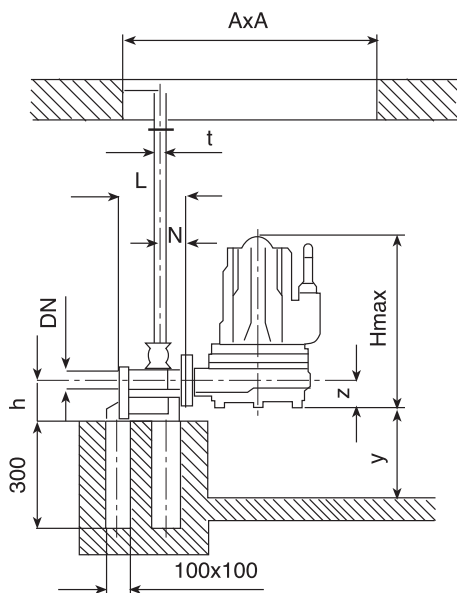

B	E	F	S	N	L
348	148	148	401	81	201

M1	M	h	Hmax	t	c
140	180	125	478	30x40	200

f	y	z	AxAmin	DN
14	100	75	650	2"

Type	P2 kW	rpm	DN	Weight kg
GMG 40-120	1.5	2800	1 1/2"	44
GMG 40-130	1.5	2800	1 1/2"	44
GMG 40-140	2.2	2800	1 1/2"	44
GMG 50A-150	3	2850	2"	68
GMG 50A-160	3	2850	2"	68
GMG 50A-170	3	2850	2"	68

Type	P2 kW	rpm	DN	Weight kg
GMG 50B-180	4	2850	2"	69
GMG 50B-190	4	2850	2"	69
GMG 50B-200	4	2850	2"	69
GMG 50C-130	3	2850	2"	65
GMG 50C-140	3	2850	2"	65
GMG 50C-150	4	2850	2"	67

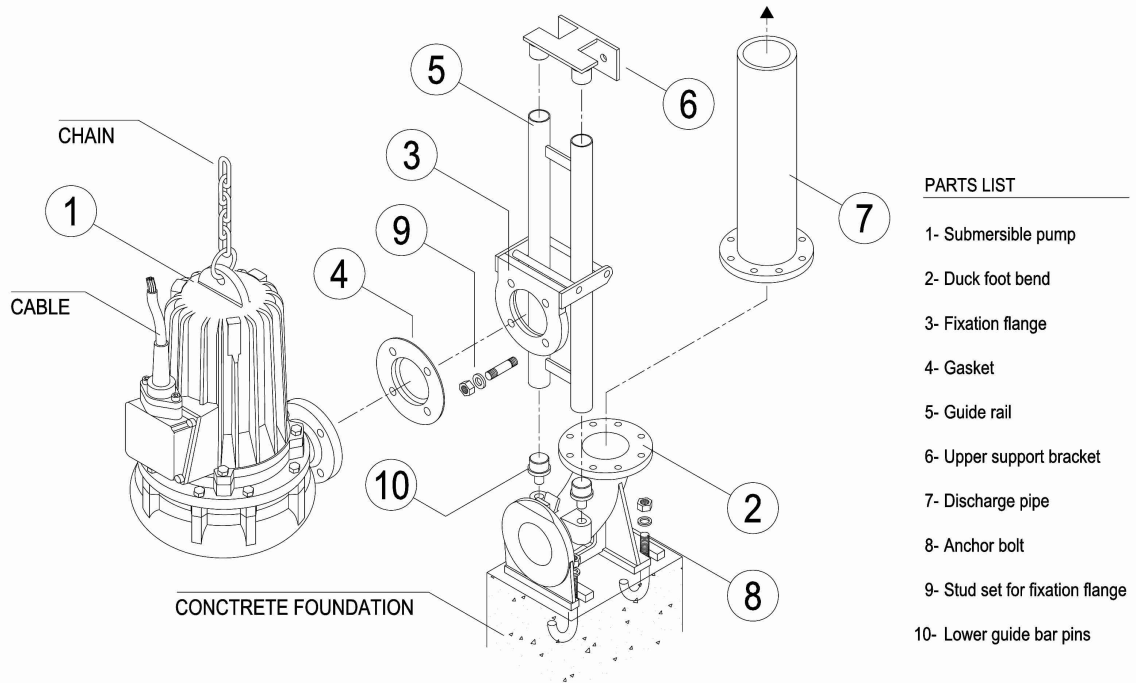

NOTE: Use CHAIN for lifting or lowering the pump. Never pull cable for this purpose.

